

## DISASSEMBLY

### 1. REMOVE DUST PROTECTOR

### 2. REMOVE FIELD FRAME AND ARMATURE

- (a) Remove the nut, and disconnect the lead wire from the magnetic switch terminal.

**Torque: 5.9 N·m (60 kgf-cm, 52 in.-lbf)**

- (b) Remove the 2 through bolts.

**Torque: 5.9 N·m (60 kgf-cm, 52 in.-lbf)**

- (c) Pull out the field frame together with the armature.

**HINT:**

Align the protrusion of the field frame with the groove of the magnetic switch.

- (d) Remove the O-ring from the field frame.

**HINT:**

At the time of installation, please refer to the following items. Use a new O-ring.

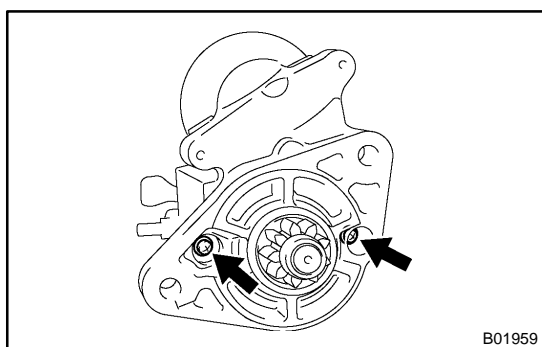
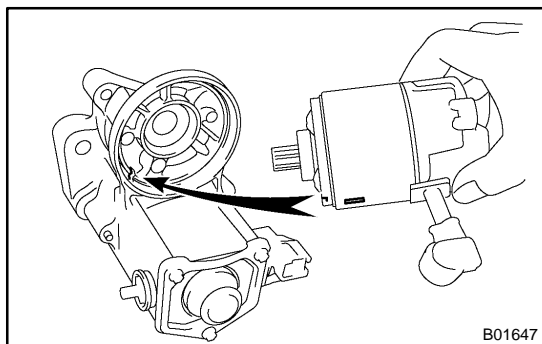

### 3. REMOVE STARTER HOUSING, CLUTCH ASSEMBLY AND GEAR

- (a) Remove the 2 bolts.

**Torque: 5.9 N·m (60 kgf-cm, 52 in.-lbf)**

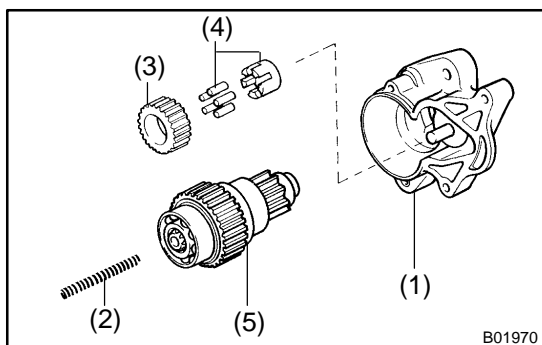

- (b) Remove these parts from the magnetic switch:

- (1) Starter housing
- (2) Return spring
- (3) Idler gear
- (4) Bearing
- (5) Clutch assembly

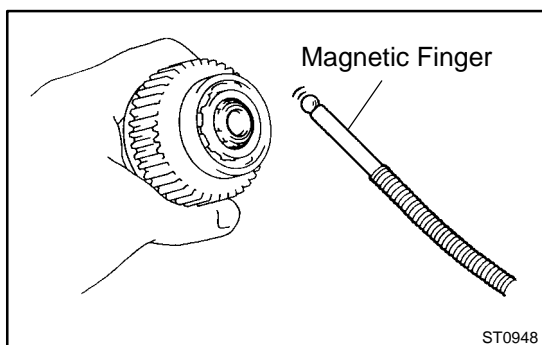

### 4. REMOVE STEEL BALL

Using a magnetic finger, remove the steel ball from the clutch shaft hole.

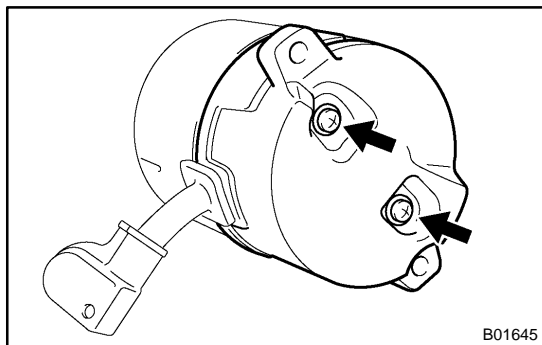
**5. REMOVE BRUSH HOLDER**

- (a) Remove the 2 screws and end cover from the field frame.

**Torque: 1.5 N·m (15 kgf·cm, 13 in.-lbf)**

- (b) Remove the O-ring from the field frame.

**HINT:**

At the time of installation, please refer to the following items.  
Use a new O-ring.

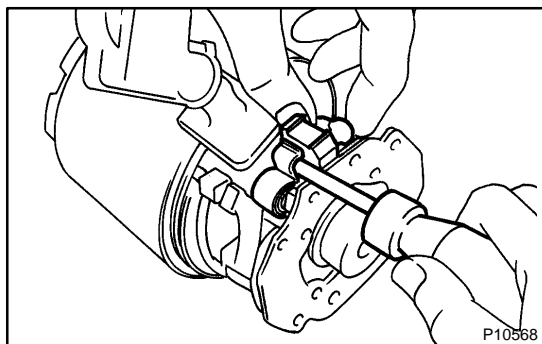

- (c) Using a screwdriver, hold the spring back and disconnect the brush from the brush holder. Disconnect the 4 brushes, and remove the brush holder.

**NOTICE:**

**Check that the positive (+) lead wires are not grounded.**

**6. REMOVE ARMATURE FROM FIELD FRAME**